

RESOURCE AREA & PLAN ELEMENTS DIAGRAM

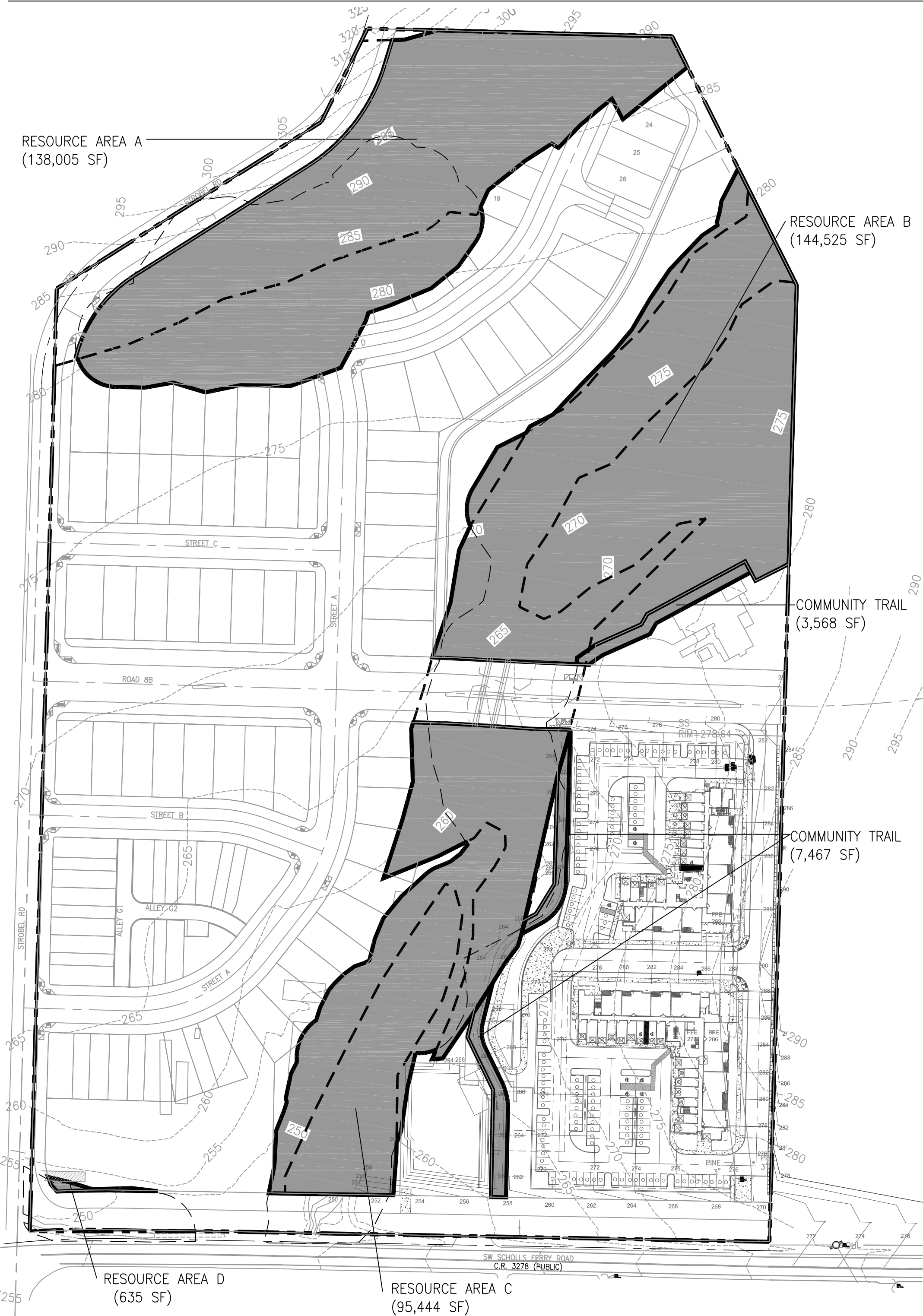

The Ridge at South Cooper Mountain
Resource Area and Community Plan Elements
The Ridge at South Cooper Mountain
Resource Area and Community Plan Elements

	Area (sf)	Area (ac)
Resource Area A	138,005	3.17
Resource Area B	144,525	3.32
Resource Area C	95,444	2.19
Resource Area D	635	0.01
Community Trail on east side of VC, north of Collector 8B	3,568	0.08
Community Trail along east side of creek, south of Collector 8B	7,467	0.17
Total	389,644	8.94
Active Open Space Requirement (25%)		2.24
Total Site Area		28.08
Total Site Area		28.08
Percentage of Resource and Plan elements		31.7%

ACTIVE OPEN SPACE DIAGRAM

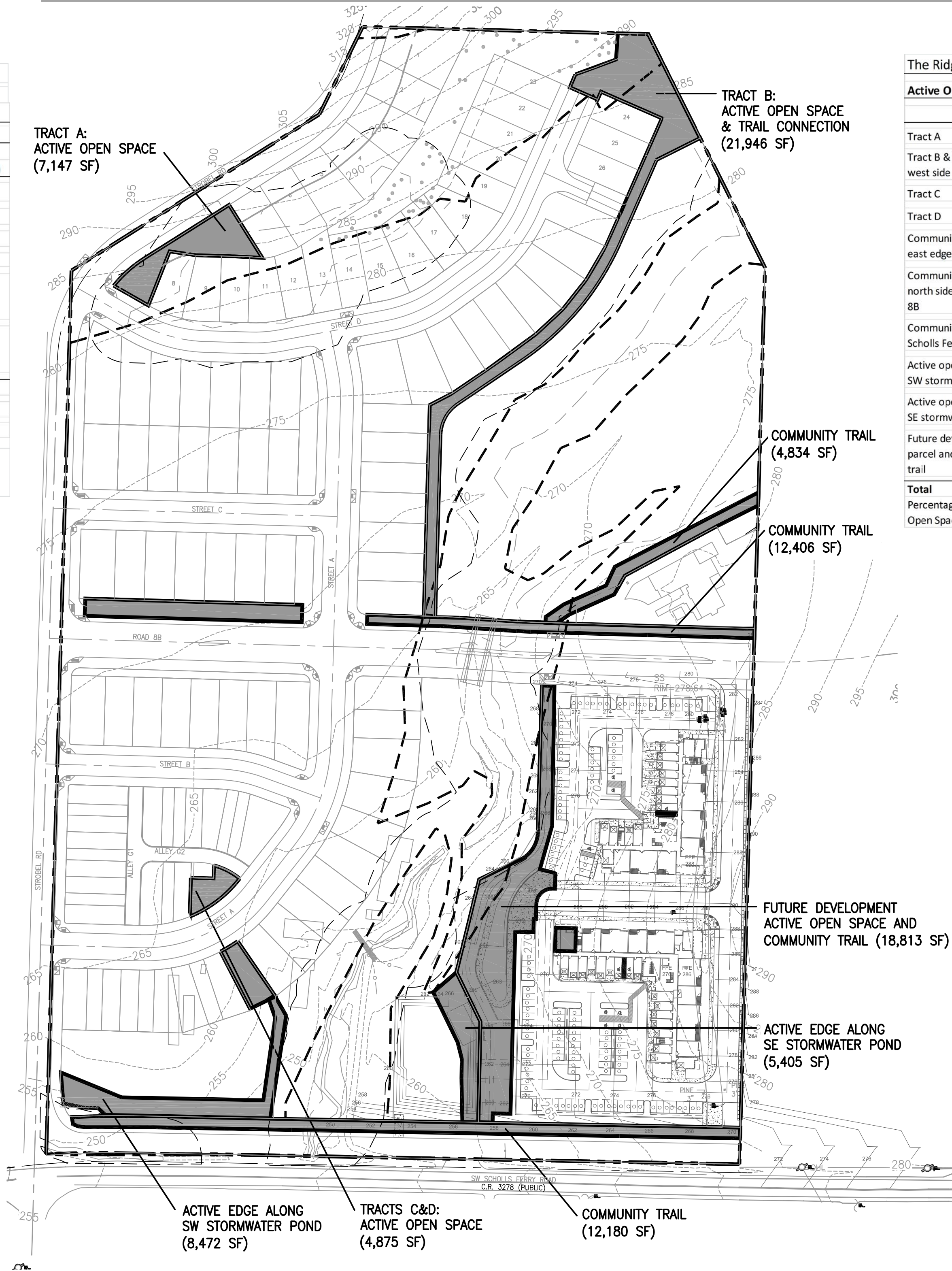

The Ridge at South Cooper Mountain
Active Open Space

	Area (sf)	Area (ac)
Tract A	7,147	0.16
Tract B & trail along west side of VC	21,946	0.50
Tract C	2,216	0.05
Tract D	2,659	0.06
Community Trail along east edge of VC	4,834	0.11
Community Trail along north side of Collector 8B	14,323	0.33
Community Trail along Scholls Ferry Road	12,180	0.28
Active open space in SW stormwater pond	8,472	0.19
Active open space in SE stormwater pond	5,405	0.12
Future development parcel and Community trail	18,813	0.43
Total	97,995	2.25
Percentage of Active Open Space		25.1%

THE RIDGE AT SOUTH COOPER MOUNTAIN
SOUTH COOPER MOUNTAIN, BEAVERTON, OR
OPEN SPACE DIAGRAMS

808 SW 3rd Ave., Ste. 300
Portland, OR 97204
Phone: (503) 287-6825
Fax: (503) 415-2304
www.otak.com

Project No. Drawing No.
Sheet No.

© Otak, Inc. 2017

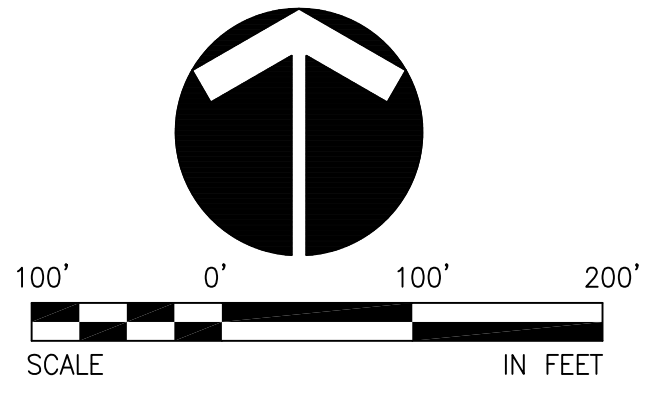

Plotted: Jun 20, 2017 - 10:08pm L:\Project\17800\17800\CAD\ACAD\Draw\Exhibits\Open Space Diagrams\17800\open space cases_2017_0612.dwg Layout Name: RA DA

XX/XX